

ROOFTOP SAFETY SYSTEMS COMPLETE SOLUTIONS FOR WORKING AT HEIGHTS



MADE IN AMERICA



SAFETY SOLUTIONS BUILT AROUND YOUR ROOFTOP NEEDS

We don't just offer products. We deliver comprehensive rooftop safety solutions that reduce risk, simplify installation, and help you meet compliance standards with ease.

CONTENTS

Rooftop Safety Products	04
Rooftop Safety Audit	06
Gargoyle Rooftop Guardrail	08
Roof Hatch Guardrail	10
Roof Access Hatches	11
Skylight Guardrail	12
Skylight Covers	13
Modular Crossover Stairs	14
Modular Fixed Ladders	15
Modular Stairs	16
Ladder and Crossover Systems	17
Custom Stairs and Ladders	18
Rooftop Walkway	20
Roof Walkway Matting	21
Work Platform Series	22
Warning Lines	23
Fall Arrest Anchors	23

ROOFTOP SAFETY PRODUCTS



Falls are the second leading cause of accidental injuries and deaths worldwide, with an estimated 646,000 fatalities each year. The most concerning part? Many of these falls are 100% preventable with fall protection systems. Explore our full range of **rooftop safety products** and take a proactive step toward preventing avoidable accidents.

Engineered to eliminate the need for permanent rooftop attachment, our counterweighted baseplates are stackable and lightweight (40 lbs each).





COUNTERWEIGHTED BASEPLATES: no rooftop penetration required



ONE TOOL FOR ASSEMBLE

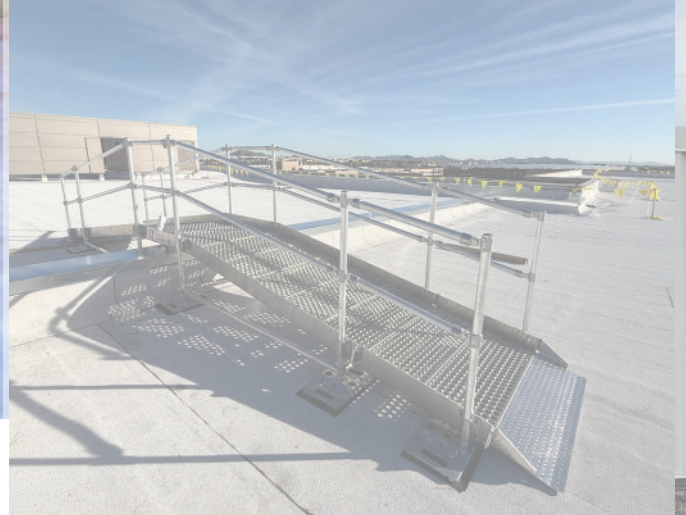

**SCAN THE QR CODE TO
VISIT OUR WEBSITE**



ROOFTOP RISK ZONES & FALL PROTECTION REQUIREMENTS

1

GUARDRAILS WITH TOE-BOARDS

Recommended over access doors, walkways, or areas where people work below. OSHA 1910.28(c)(1)

2

ROOF HATCHES (OPEN)

Considered a fall hazard (“hole”); must be protected (guardrails, covers). OSHA 1910.28(b)(3)(i, iv)

3

FIXED LADDERS (OVER 24 FT)

Require a ladder safety device or fall protection anchor. OSHA 1910.28(b)(9)(i)

4

SKYLIGHTS

Must be guarded (e.g., screens, guardrail, covers). OSHA 1910.28(b)(3)(i)

5

EQUIPMENT NEAR FALL HAZARDS (WITHIN 15 FT)

Fall protection required (guardrails, anchor).
Exception (6–15 ft): Temporary/infrequent work may use warning lines. OSHA 1910.28(b)(13)(ii)

6

WORK NEAR UNPROTECTED EDGES (WITHIN 15 FT)

Fall protection required (guardrails, anchor).
Exception (6–15 ft): Temporary/infrequent work may use warning lines. OSHA 1910.28(b)(13)(iii)(A)

7

OBSTACLES/ELEVATION CHANGES (OVER 19 IN)

Safe access (e.g., ramps, steps) must be provided. OSHA 1926.1051(a)

GREEN ZONE = 15FT+

ORANGE ZONE = 6-15FT

RED ZONE = 0-6FT

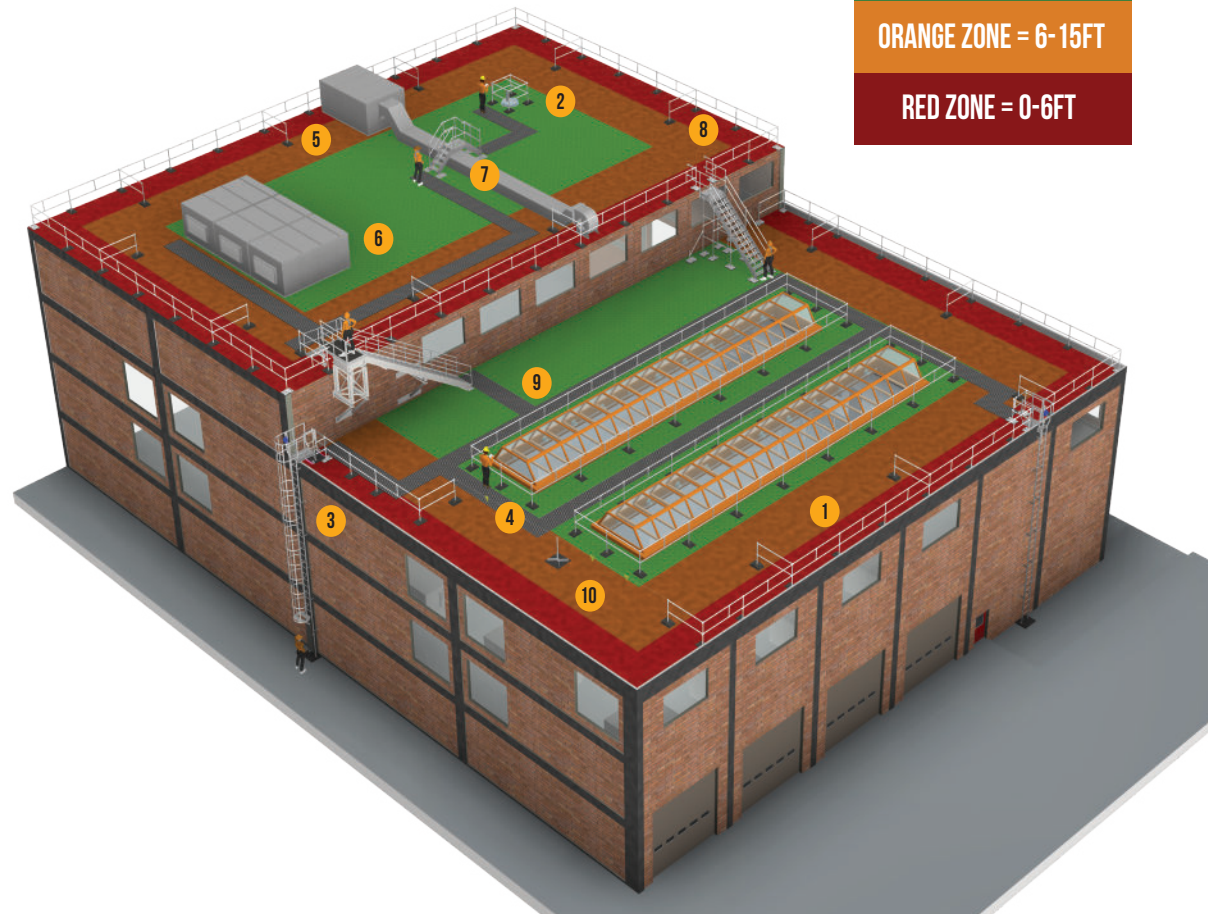

8

LOW PARAPET WALLS (LESS THAN 39 IN)

Fall protection required (e.g., guardrails). OSHA 1910.29(b)(1)

9

DESIGNATED WALKWAYS

Clearly marked walkways and training can mitigate hazards (e.g., guardrail walkways). OSHA 1910.22(c)

10

DESIGNATED WALKWAYS

Clearly marked walkways and training can mitigate hazards (e.g., guardrail walkways). OSHA 1910.22(c)



6 STAGES OF ROOFTOP SAFETY

ROOFTOP PROTECTION PROGRAM

Our rooftop protection program uses 6 stages to systematically assess fall hazards on rooftops, prioritize risks, and implement compliant safety solutions. The program follows industry best practices and regulatory requirements (OSHA, CCOHS, local OH&S codes) to ensure worker safety.

1 COMPREHENSIVE ROOFTOP HAZARD MAPPING

Before any rooftop access, our team conducts a thorough virtual assessment to identify and mitigate fall hazards. Using building plans, google imaging, and site inspections, we document:

- Hazard Locations: Skylights, edges, equipment zones
- Access Points: Ladders, hatches, and stairwells
- Work Areas: High-traffic zones requiring protection

This proactive review allows us to plan safe routes to avoid edge exposure and develop task-specific safety plans.

4 DEFINE SAFE ZONES & WALKWAYS

The best fall protection plan will actively guide workers away from fall hazards through clearly defined, safe travel routes. All walkways must be visibly marked with slip-resistant surfaces and free of obstructions that might force workers near unprotected edges. Any elevation changes exceeding 19 inches require proper ramps or stairs.

ROOFTOP SAFETY SOLUTIONS

- Walkways
- Guardrails systems
- Warning lines

2 ROOF ACCESS EVALUATION

When entering a rooftop ensure that all rooftop entry and exit points meet OSHA compliance and eliminate fall exposure. Take the time to verify that fixed ladders, hatches, and stair systems have proper guardrails or self-closing gates, portable ladders are securely stabilized, and no transitional gaps or awkward movements put workers at risk.

ROOFTOP SAFETY SOLUTIONS

- Fixed ladders
- Ladder guardrail systems
- Roof hatch guardrail
- Self-closing safety gates
- Safety stair systems
- Ladder brackets

5 PROTECT WORK ZONES NEAR EDGES

Secure all work areas and equipment within 15 feet of unprotected edges with the appropriate fall protection solutions. Any permanent equipment near roof edges must be protected with guardrails or restraint systems, while temporary warning lines between 6-15 feet may only be used for infrequent tasks.

ROOFTOP SAFETY SOLUTIONS

- Fall arrest system
- Guardrail systems
- Warning lines
- Roof hatch guardrail
- Walkways

3 ELIMINATE ENTRANCE HAZARDS

Obstacles, uneven transitions, and tight clearance at entry points create real danger. It is important to remove all fall and injury risks at initial rooftop access locations by ensuring clear, unobstructed entry paths. Inspect for hazards and eliminate any need for workers to crouch, climb over obstacles, or make awkward movements when entering a roof.

ROOFTOP SAFETY SOLUTIONS

- Guardrail systems
- Roof hatch guardrail
- Non-slip transition platforms
- Self-closing gates
- Toe boards

6 ROOF EDGE & PERIMETER SAFETY

By systematically implementing the previous stages - from access point controls to work zone protections - the most critical edge risks should now be protected. However, all remaining parameters require either OSHA-compliant guardrails or passive fall protection solutions. This ensures every safety control exists at every unprotected edge.

ROOFTOP SAFETY SOLUTIONS

- Guardrail systems
- Fall arrest system
- Fall restraint systems
- Warning lines

ROOFTOP GUARDRAIL GARGOYLE SERIES



9 FOOT KIT

- NON-PENETRATING SYSTEM
- EASY INSTALLATION
- MODULAR DESIGN
- OSHA COMPLIANT
- 5-YEAR WARRANTY



Modular, non-penetrating system designed to eliminate the potential hazard of falls over unprotected edges on rooftops or elevated surfaces. This **passive fall protection system** removes the need for active fall protection equipment and ongoing training requirements. Additionally, it is a versatile, economical, and modular solution that can be configured to meet the specific needs of your facility.

* Powder coating available at an upcharge.

12 FOOT KIT



SCAN FOR FULL
SKU DETAILS

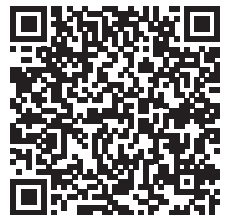

ADDITIONAL ROOFTOP GUARDRAIL KITS

DESIGNED TO MEET CAL-OSHA AND WASHINGTON DOSH ROOFTOP SAFETY STANDARDS



18 FOOT KIT

27 FOOT KIT



8 FOOT KIT



16 FOOT KIT



24 FOOT KIT

ROOF HATCH GUARDRAIL



SCAN FOR FULL
SKU DETAILS

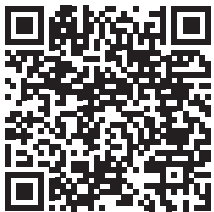

- NON-PENETRATING SYSTEM
- EASY INSTALLATION
- MODULAR DESIGN
- OSHA COMPLIANT
- 5-YEAR WARRANTY

Roof Hatch Guardrails are a freestanding, modular safety solution designed to integrate seamlessly with almost any roof hatch or rooftop opening. Constructed from lightweight, corrosion-resistant aluminum tubing, it features counterweighted baseplates that eliminate the need for rooftop penetration, helping to prevent leaks and maintaining roof integrity.

* Powder coating available at an upcharge.

KIT SIZE

SKU

4 FOOT BY 4 FOOT

HG-KIT-08

4 FOOT BY 6 FOOT

HG-KIT-4X6

6 FOOT BY 6 FOOT

HG-KIT-6X6

4 FOOT BY 8 FOOT

HG-KIT-4X8

4 FOOT BY 10 FOOT

HG-KIT-4X10

ROOF ACCESS HATCHES

Built for durability and performance, our Roof Access Hatches provide superior weather resistance in a convenient, easy-to-order stock model. Constructed galvanized steel or aluminum and finished with a standard red oxide powder-coat, they offer exceptional protection against rust for long-term durability. These insulated hatches help prevent frost and condensation, are available in a variety of materials and finishes, and are fully customizable. They **meet or exceed OSHA** standards and are **Miami-Dade and Florida approved**.



SIZE	MATERIAL	ACCESS
36" X 30"	STEEL	LADDER
36" X 36"	STEEL	LADDER
30" X 54"	STEEL	SHIP STAIR OR ALTERNATING TREAD
30" X 96"	STEEL	SERVICE STAIR
36" X 30"	ALUMINUM	LADDER
36" X 36"	ALUMINUM	LADDER
48" X 48"	ALUMINUM	LADDER
30" X 54"	ALUMINUM	SHIP STAIR OR ALTERNATING TREAD
30" X 96"	ALUMINUM	SERVICE STAIR

SKYLIGHT GUARDRAIL



SCAN FOR FULL
SKU DETAILS



- NON-PENETRATING SYSTEM
- EASY INSTALLATION
- MODULAR DESIGN
- OSHA COMPLIANT
- 5-YEAR WARRANTY

Engineered to provide reliable fall protection for skylights and ensure **full OSHA compliance**, our **Skylight Guardrails** maximize safety without compromising natural light. The modular design integrates seamlessly with most skylight types and sizes and is constructed from corrosion-resistant materials with counterweighted baseplates. This durable, non-penetrating system preserves roof integrity and comes partially pre-assembled with intuitive, easy-to-follow instructions for quick installation.

* Powder coating available at an upcharge.

KIT SIZE

SKU

4 FOOT BY 4 FOOT

RGC-KIT-SKY44

4 FOOT BY 6 FOOT

RGC-KIT-SKY46

6 FOOT BY 6 FOOT

RGC-KIT-SKY66

9 FOOT BY 9 FOOT

RGC-KIT-SKY99

Our **Skylight Covers** are durable, **OSHA-approved** wire mesh systems designed to prevent accidental falls through skylights. These safety covers can be custom-fabricated to fit any size, shape, or configuration. Constructed from weather-resistant acrylic materials, they are built to withstand harsh environments and provide long-lasting protection.



SKYLIGHT COVERS

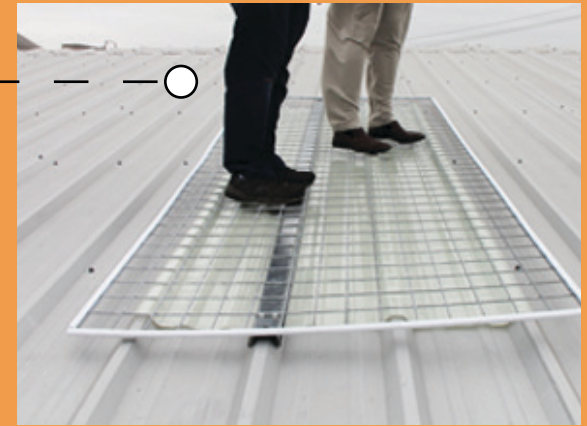

SCAN FOR FULL SKU DETAILS

MODULAR CROSSOVER STAIRS



SCAN FOR FULL
SKU DETAILS



Our **Modular Crossover Stairs** provide safe, **OSHA-compliant** access over rooftop obstacles, with platforms wide enough to support the safe transport of tools and equipment. Its modular, custom-engineered design allows for fast installation with no special tools or on-site welding required. Built with galvanized steel, anodized aluminum, and counterweighted baseplates that protect the roof membrane, these **Modular Crossover Stairs** offer long-lasting durability and weather resistance. The system is fully customizable, easy to adapt, and **meets or exceeds all OSHA standards**.

* Powder coating available at an upcharge.

- **MULTIPLE MOUNTING OPTIONS**
- **CORROSION RESISTANT**
- **EASY INSTALLATION**
- **MODULAR DESIGN**
- **OSHA COMPLIANT**
- **5-YEAR WARRANTY**

MODULAR FIXED LADDERS

Modular Fixed Ladders provide safe, **OSHA-compliant** access to rooftops and elevated surfaces. Constructed from lightweight, corrosion-resistant aluminum, they're designed for fast, weld-free installation. Standardized 4' and 6' sections allow for quick shipping, simple assembly, and flexible height customization, making them a versatile access solution for a wide range of commercial and industrial applications.

* Powder coating available at an upcharge.

- EASY INSTALLATION
- OSHA COMPLIANT
- WALL HARDWARES INCLUDED
- MODULAR DESIGN
- 5-YEAR WARRANTY

SCAN FOR FULL
SKU DETAILS

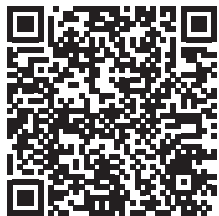

MODULAR STAIRS

Our **Modular Stairs** are engineered for fast installation, long-term durability, and maximum adaptability, making them an ideal solution for safe, **OSHA-compliant** rooftop access. Built from corrosion-resistant aluminum and steel, each system features non-slip treads, sturdy handrails, and counterweighted, non-penetrating baseplates that protect rooftop membranes without requiring drilling. With a standard 36" stair width, these systems easily accommodate workers and equipment, and are available in both standard and fully customizable configurations to match various rooftop layouts and elevation changes.

* Powder coating available at an upcharge.

- **MULTIPLE MOUNTING OPTIONS**
- **CORROSION RESISTANT**
- **EASY INSTALLATION**
- **MODULAR DESIGN**
- **OSHA COMPLIANT**
- **5-YEAR WARRANTY**



SCAN FOR FULL
SKU DETAILS

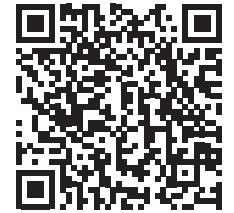

LADDER SERIES (LD) SYSTEMS

The **Ladder Series (LD) systems** enable workers to move from one level to another with guardrails on the upper elevation to help prevent a fall to the lower level. This freestanding system is constructed with corrosion resistant lightweight aluminum tubing and utilizes counterweighted baseplates.



SCAN FOR FULL
SKU DETAILS

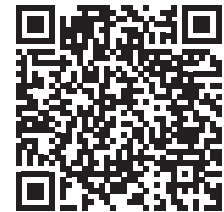

CROSSOVER SERIES (XS) SYSTEMS

SCAN FOR FULL
SKU DETAILS



The **Crossover Series (XS) systems** help workers move up and over obstructions on the rooftop and have 45-degree bracing on both sides for stability. They are counterweighted, freestanding fall protection systems which provide safe and reliable access up and over elevation changes.

CUSTOM STAIRS AND LADDERS

With over 25 years of experience in the design, fabrication, and installation of fixed access ladders and rooftop stair systems, **Factory Supply** delivers reliable, code-compliant solutions for safe rooftop access. Available in both steel and aluminum, each ladder and stair system is engineered to **exceed OSHA, CAL/WA OSHA, and ANSI safety standards**. Options range from standard off-the-shelf designs to fully customized rooftop access systems, ensuring the right fit for any application.

* Powder coating available at an upcharge.

- CUSTOMIZABLE DESIGN
- CORROSION RESISTANT
- EASY INSTALLATION
- NON-SLIP
- OSHA COMPLIANT
- 5-YEAR WARRANTY

SCAN FOR FULL
SKU DETAILS

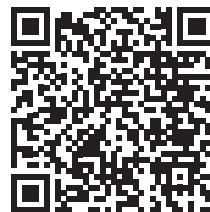



ROOFTOP WALKWAY



The **Rooftop Walkway RoofWalk Series** is designed to create a sure-footed walkway on your rooftop. This fully customizable platform utilizes non slip materials and is installed above the roof membrane ensuring no damage is being done while in use. It can be tailored to any flat roof or low slope application, providing safer access to any workspace by eliminating slipping and fall hazards.

* Powder coating available at an upcharge.

- **NON-PENETRATING SYSTEM**
- **EASY INSTALLATION**
- **MODULAR DESIGN**
- **OSHA COMPLIANT**
- **5-YEAR WARRANTY**

SCAN FOR FULL
SKU DETAILS



ROOF WALKWAY MATTING

Roof Walkway Matting is engineered to protect rooftop surfaces and provide safe, slip-resistant access for foot traffic. Designed to be loose laid with no fixings required, it can be installed in any weather, even in wet conditions or areas with ponding water. The matting comes in a convenient rolled format for quick and easy installation.



SCAN FOR FULL
SKU DETAILS



WORK PLATFORM SERIES



Custom rooftop maintenance platforms with integrated guardrail systems provide **OSHA-compliant fall protection** and safe, elevated access for equipment maintenance. Built to meet site-specific requirements, each system features modular construction for easy reconfiguration, improved accessibility, and low-maintenance materials. Designed to enhance efficiency while reducing the risk of falls or injuries, these platforms can be customized in various heights and layouts to complement existing rooftop structures.

* Powder coating available at an upcharge.

SCAN FOR FULL
SKU DETAILS



- **NON-PENETRATING SYSTEM**
- **CORROSION RESISTANT**
- **EASY INSTALLATION**
- **MODULAR DESIGN**
- **OSHA COMPLIANT**
- **5-YEAR WARRANTY**

WARNING LINES



SCAN FOR FULL
SKU DETAILS



Warning Lines are designed for accessing areas of a flat rooftop that are nearing the roof edge (but not within 2m) to provide a visual warning to workers that are approaching a hazard. This freestanding system avoids piercing the roofing membrane to prevent leaks and can be customized to the rooftop layout. Properly installed, it creates a designated work zone where extra fall protection may not be required.

FALL ARREST ANCHORS

Designed for workers near roof edges, our **Fall Arrest Anchor** is a non-penetrating, portable, counterweighted fall protection system. This system offers the flexibility to position anchor points exactly where needed—helping ensure **OSHA-compliant safety**. Each anchor kit is shipped on a single pallet with 32 counterweight baseplates, pre-assembled vertical posts, and a horizontal crossing attachment bracket with integrated anchor point.



SCAN FOR FULL
SKU DETAILS



FS

MADE IN AMERICA

