



LIFTSAFE



FACTORY
SUPPLY

Installation Manual:

Modular Stairs RoofStair Series

This Installation Manual is intended to meet the Manufacturer's Instructions requirements and should be used as part of an employee training program.

WARNINGS AND CONDITIONS

These instructions must be provided to the installer of this system. The installer must read and understand these instructions and follow.

Failure to follow these instructions or the details of the unique layout drawing provided may result in serious injury or death. If you have any questions about this system's use or care, please contact the manufacturer: 1-800-977-2005 (Canada) or 1-888-242-3045 (US).



Modular Stairs RoofStair Series

Table of Contents

Required / Suggested Tool List..... 3

Component Identification..... 4

Typical Bill of Material for Stair Assembly..... 5

Stair to Stair Assembly..... 6

Stair to Platform Assembly..... 7

Platform Handrail Assembly..... 8

Stair Handrail Assembly..... 9

Floor Support Assembly..... 10

Support Post Assembly..... 11

Platform Support Post Assembly..... 12



WARNING

IMPROPER USE OR INSTALLATION OF THIS EQUIPMENT MAY CAUSE INJURY OR DEATH

Failure to Read, Understand, and Follow the Installation Manual may result in injury or death

- DO NOT** stand or climb on stair and platform handrail
- DO NOT** use handrail as a tie-off point
- DO NOT** use handrail for lifting or hoisting
- DO NOT** install modular stairs within 10-feet of any electrical lines
- DO NOT** use if any component is found defective or damaged
- DO NOT** attach banners, signs, or equipment to any part of the modular stairs

DO read and follow this document (Installation Manual) for assembling and mounting the Modular Stairs RoofStair Series.

Modular Stairs RoofStair Series systems are designed and are to be used only for their intended purpose. The use of these stair systems or their individual components for any other purpose **may cause injury or death.**

Required / Suggested Tool List

- Tape measure
- 2 ft level
- Hammer
- Allen keys (SAE)
- Wrenches (SAE)
- Step ladder or manlift (to be determined based on ladder height)



WARNING

**Failure to Read, Understand, and Follow the Installation Manual
may result in injury or death**

Figure 1 - Component Identification



① 17-8-1.50



② RGF-060

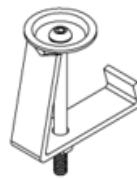

③ RC-434-AJC



④ RGF-CAP

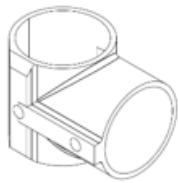

⑤ RGF-010

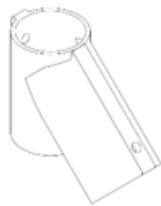

⑥ RGF-145

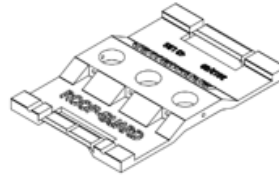

⑦ RG-BASEPLATE2

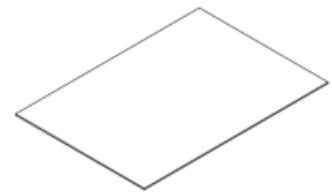

⑧ RG-PAD-RUBBER

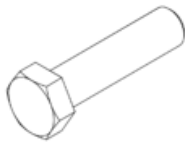

⑨ HS050C200SS18-8



⑩ FW050X106X17SS18-8



⑪ LW050LCSS18-8



⑫ HN050CSS18-8



WARNING

Failure to Read, Understand, and Follow the Installation Manual
may result in injury or death

Typical Bill of Material for Stair Assembly

*BOM IS FOR QTY OF ONE			
ITEM	MATERIAL CODE	DESCRIPTION	QTY
1	RG-BASEPLATE2	RoofGuard, 2nd Generation Base Plate 40 lbs	16
2	RG-PAD-RUBBER	Underpad, 1/8" Masticated Rubber, .125" x 14" x 20"	12
3	RC-434-P3	GRATING CAP PLATE, 1/4" PL. 6061 ALUMINUM	1
4	17-8-1.50	ADJUSTABLE TEE FITTING, FOR 1-1/2" SCH.40 PIPE	16
5	RGF-010	FITTING, TEE, SINGLE SOCKET, 08060	24
6	RGF-060	FITTING, CROSS E, TWO SOCKETS, 08100	4
7	RGF-145	FITTING, ANGLE TEE 45 deg., 08080	4
8	RGF-152E-8	FLANGE FITTING, 4 HOLE	4
9	RGF-CAP	PLASTIC PLUG FITTING, FOR 1-1/2" SCH.40 PIPE	18
10	RC-434-ST36	STAIR TREAD, FABRICATED 10"W x 2"H x 36"L X .125"	14
11	RC-434-P2	PLATFORM END PLATE, 1/4" PL. 5052 ALUMINUM	2
12-28	MP019-145-AL	PIPE, ALUM 1 1/2 SCH 40 (0.93#/FT) - various lengths to suit	-
29	P25-2875-05	PLATFORM SIDE FRAME, 1/4" PL. 5052 ALUMINUM	1
30	P25-2875-06	ROUND CHANNEL GRATING - 18" WIDE X 24" LG.	2
31	P25-2875-07	STAIR STRINGER LH1 - 3/8" PL. 5052 ALUMINUM	1
32	P25-2875-08	STAIR STRINGER LH2 - 3/8" PL. 5052 ALUMINUM	1
33	P25-2875-09	STAIR STRINGER RH1 - 3/8" PL. 5052 ALUMINUM	1
34	P25-2875-10	STAIR STRINGER RH2 - 3/8" PL. 5052 ALUMINUM	1
35	P25-2875-12	PLATFORM SIDE FRAME, 1/4" PL. 5052 ALUMINUM	1
36	P25-2875-19	SAFETY PLATE, 1/4" PL. 5" x 12" 6061 ALUMINUM	12
37	HS050C175SS18-8	HHCS 1/2-13 x 1.75 SS 18-8 BARE	12
38	HS050C200SS18-8	HHCS 1/2-13 x 2 SS 18-8 BARE	8
39	HN050CSS18-8	HEX NUT 1/2-13 SS 18-8 BARE	20
40	FW050X106X17SS18-8	FW - 1/2 x 1.062 x .177 SS 18-8 BARE	20
41	LW050LCSS18-8	LOCK WASHER, 1/2 Light SS 18-8 BARE	20
42	HS037C125SS18-8	HHCS 3/8-16 x 1.25 SS 18-8 BARE	72
43	HS037C150SS18-8	HHCS 3/8-16 x 1.5 SS 18-8 BARE	40
44	HN037CSS18-8	HEX NUT 3/8-16 SS 18-8 BARE	112
45	FW037X081X10SS18-8	FW - 3/8 x 0.812 x .109 SS 18-8 BARE	112
46	LW037LCSS18-8	LOCK WASHER, 3/8 Light SS 18-8 BARE	112



WARNING

Failure to Read, Understand, and Follow the Installation Manual
may result in injury or death

Figure 2 - Stair to Stair Assembly

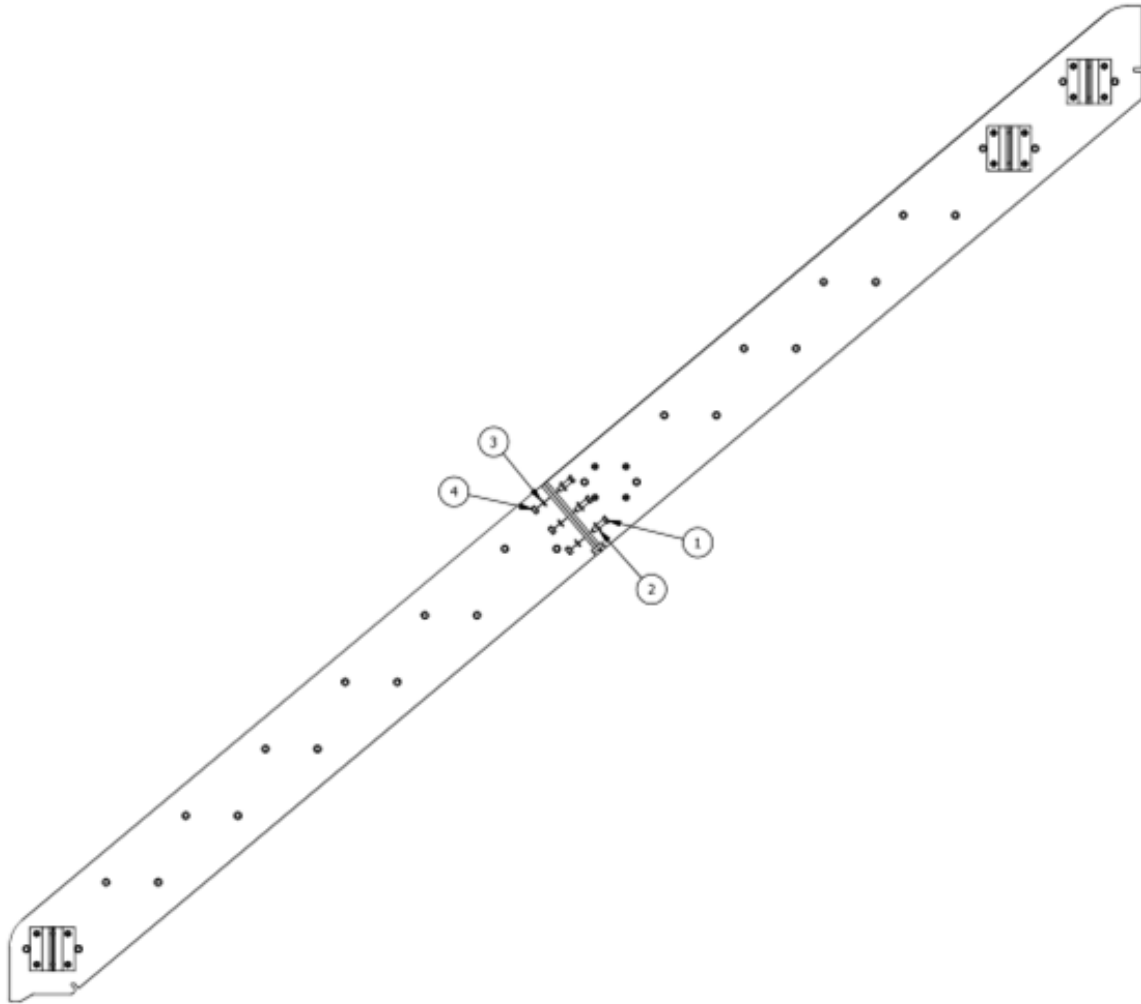

ITEM	MATERIAL CODE	DESCRIPTION	QTY
1	FW050X106X17SS18-8	FW - 1/2 X 1.062 X .177 SS 18-8 BARE	6
2	LW050LCSS18-8	LOCK WASHER, 1/2 Light SS 18-8 BARE	6
3	HN050CSS18-8	HEX NUT 1/2-13 SS18-8 BARE	6
4	HS050C175SS18-8	HHCS 1/2-13 x 1.75 SS 18-8 BARE	6

Assembly Instructions:

- Apply anti-seize to all bolts before/during assembly
- Support stair line up holes and insert hardware as per fig.



WARNING

Failure to Read, Understand, and Follow the Installation Manual
may result in injury or death

Figure 3 - Stair to Platform Assembly

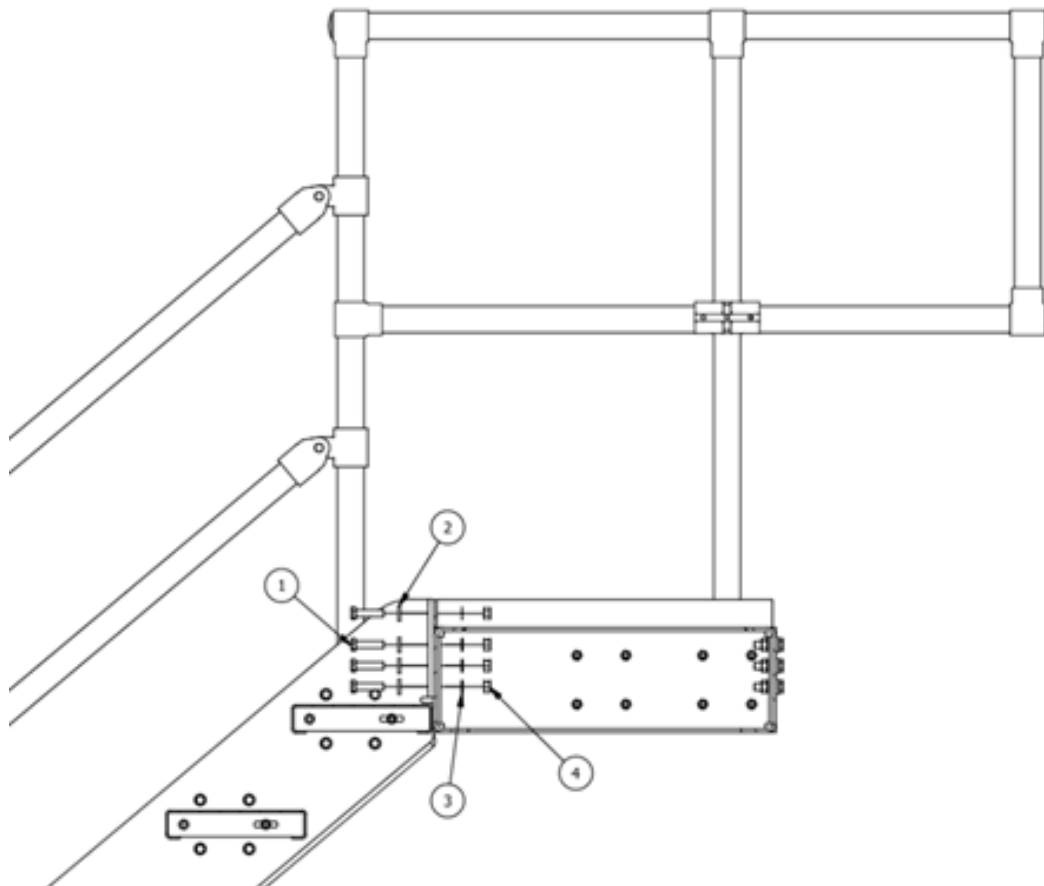

ITEM	MATERIAL CODE	DESCRIPTION	QTY
1	FW050X106X17SS18-8	FW - 1/2 X 1.062 X .177 SS 18-8 BARE	8
2	LW050LCSS18-8	LOCK WASHER, 1/2 Light SS 18-8 BARE	8
3	HN050CSS18-8	HEX NUT 1/2-13 SS18-8 BARE	8
4	HS050C175SS18-8	HHCS 1/2-13 x 1.75 SS 18-8 BARE	8

Assembly Instructions:

- Apply anti-seize to all bolts before/during assembly
- Support platform line up holes and insert hardware as per fig.



Failure to Read, Understand, and Follow the Installation Manual
may result in injury or death

Figure 4 - Platform Handrail Assembly

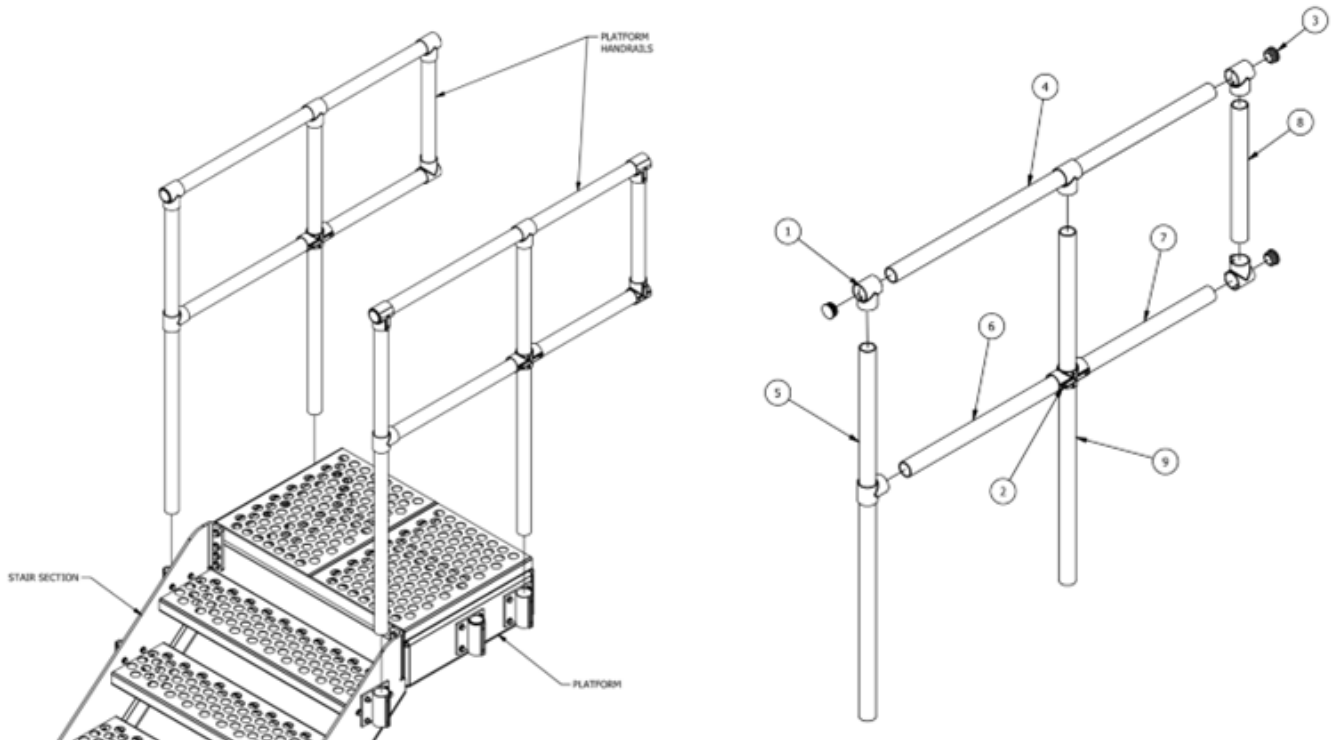

ITEM	MATERIAL CODE	DESCRIPTION	QTY
1	RGF-010	FITTING, TEE, SINGLE SOCKET, 08060	10
2	RGF-060	FITTING, CROSS E, TWO SOCKETS, 08100	2
3	RGF-CAP	PLASTIC PLUG FITTING, FOR 1-1/2" SCH.40 PIPE	6
4-9	MP019-145-AL	PIPE, ALUM 1 1/2 SCH 40 (0.93#/FT) - various lengths to suit	12

Assembly Instructions:

- Insert railing posts into flange fittings
- Tighten set screw with tube flush to bottom of fitting



Failure to Read, Understand, and Follow the Installation Manual may result in injury or death

Figure 5 - Stair Handrail Assembly

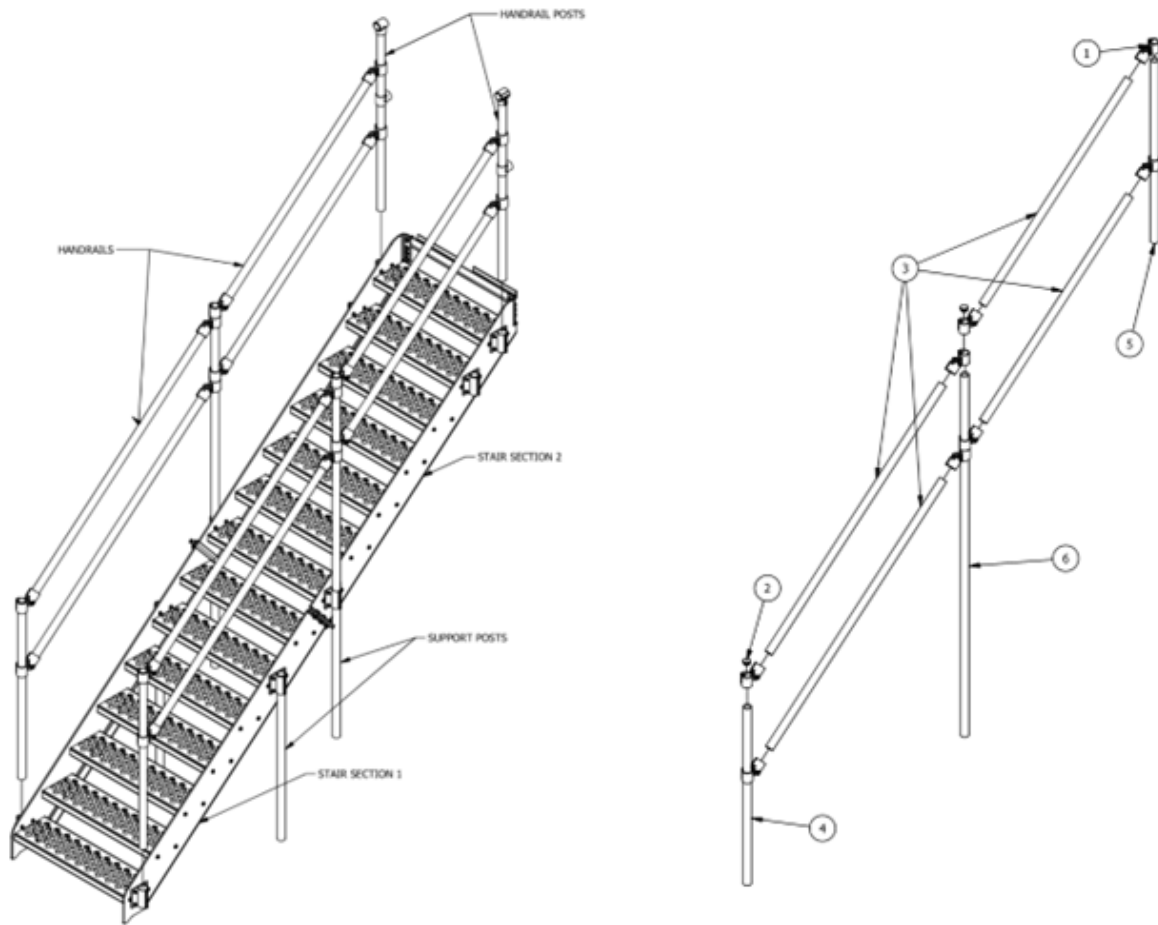

ITEM	MATERIAL CODE	DESCRIPTION	QTY
1	17-8-1.50	ADJUSTABLE TEE FITTING, FOR 1-1/2" SCH.40 PIPE	16
2	RGF-CAP	PLASTIC PLUG FITTING, FOR 1-1/2" SCH.40 PIPE	4
3-6	MP019-145-AL	PIPE, ALUM 1 1/2 SCH 40 (0.93#/FT) - various lengths to suit	14

Assembly Instructions:

- Insert railing posts into flange fittings
- Tighten set screw with tube flush to bottom of fitting



Failure to Read, Understand, and Follow the Installation Manual
may result in injury or death

Figure 6 - Floor Support Assembly

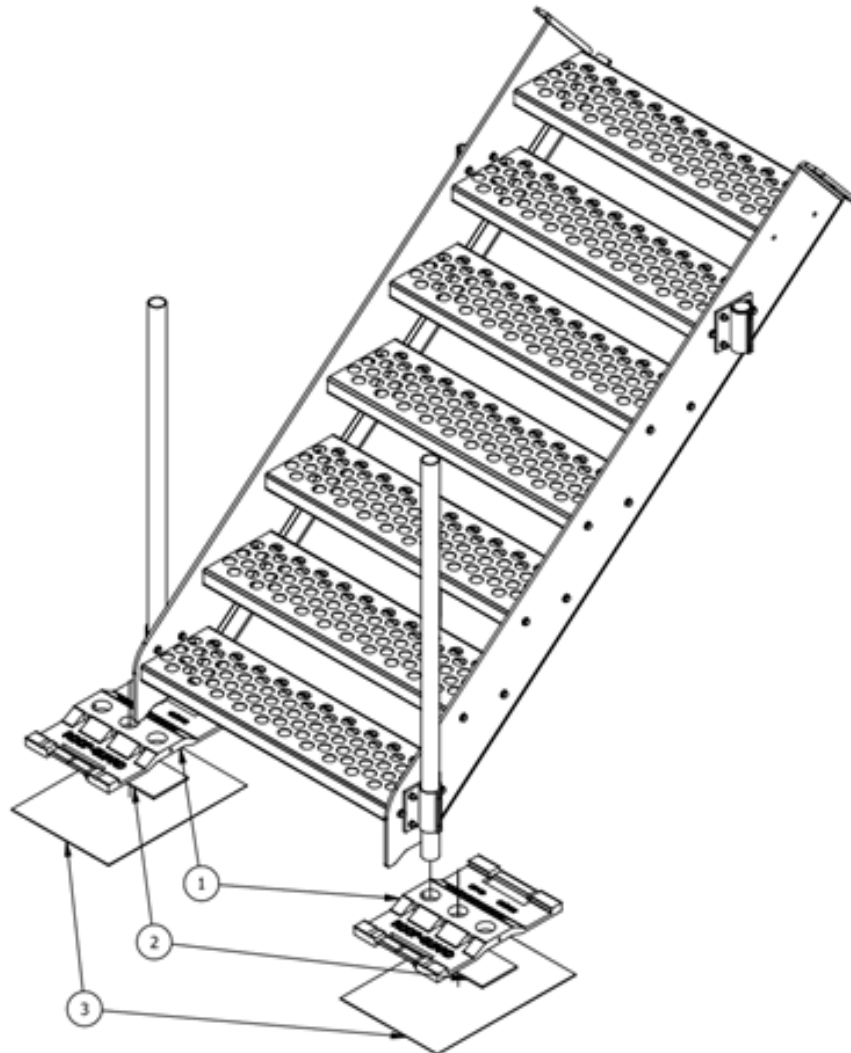

ITEM	MATERIAL CODE	DESCRIPTION	QTY
1	RG-BASEPLATE2	RoofGuard, 2nd Generation Base Plate 40 lbs	2
2	P25-2875-19	Safety Plate, 1/4" PL. 5" x 12" 6061 Aluminum (OPTIONAL)	2
3	RG-PAD-RUBBER	Underpad, 1/8" Masticated Rubber, .125" x 14" x 20"	2

Assembly Instructions:

- Insert railing posts through flange fittings into base plate
- Tube flush to bottom of baseplate
- Tighten set screw in flange fitting and baseplate



WARNING

Failure to Read, Understand, and Follow the Installation Manual
may result in injury or death

Figure 7 - Support Post Assembly

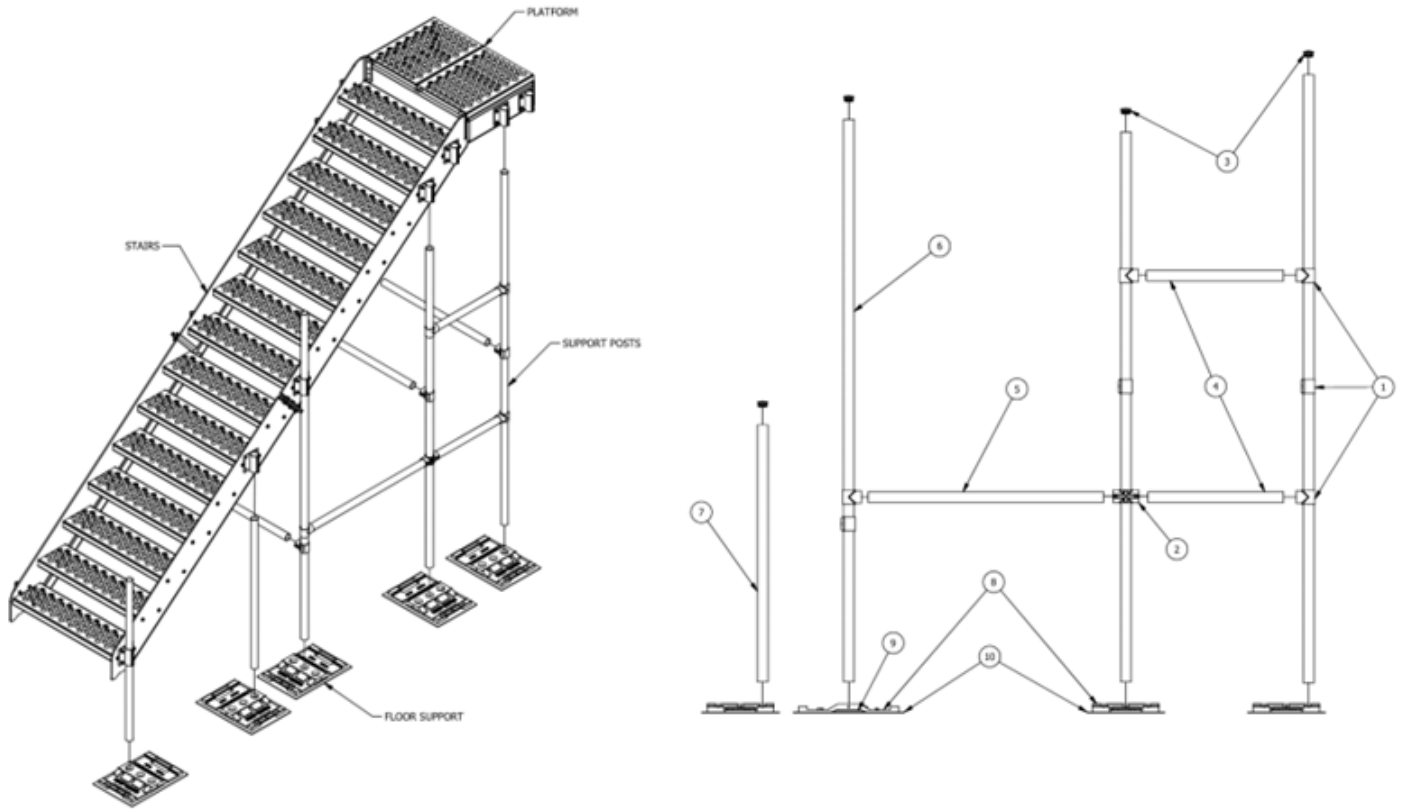

ITEM	MATERIAL CODE	DESCRIPTION	QTY
1	RGF-010	FITTING, TEE, SINGLE SOCKET, 08060	14
2	RGF-060	FITTING, CROSS E, TWO SOCKET, 08100	2
3	RGF-CAP	PLASTIC PLUG FITTING, FOR 1-1/2" SCH.40 PIPE	8
4-7	MP019-145-AL	PIPE, ALUM 1 1/2 SCH 40 (0.93#/FT) - various lengths to suit	11
8	RG-BASEPLATE2	RoofGuard, 2nd Generation Base Plate 40 lbs	8
9	P25-2875-19	Safety Plate, 1/4" PL. 5" x 12" 6061 Aluminum (OPTIONAL)	8
10	RG-PAD-RUBBER	Underpad, 1/8" Masticated Rubber, .125" x 14" x 20"	8

Assembly Instructions:

- Insert railing posts through flange fittings into base plate
- Tube flush to bottom of baseplate
- Tighten set screw in flange fitting and base plate



WARNING

Failure to Read, Understand, and Follow the Installation Manual may result in injury or death

Figure 8 - Platform Support Post Assembly

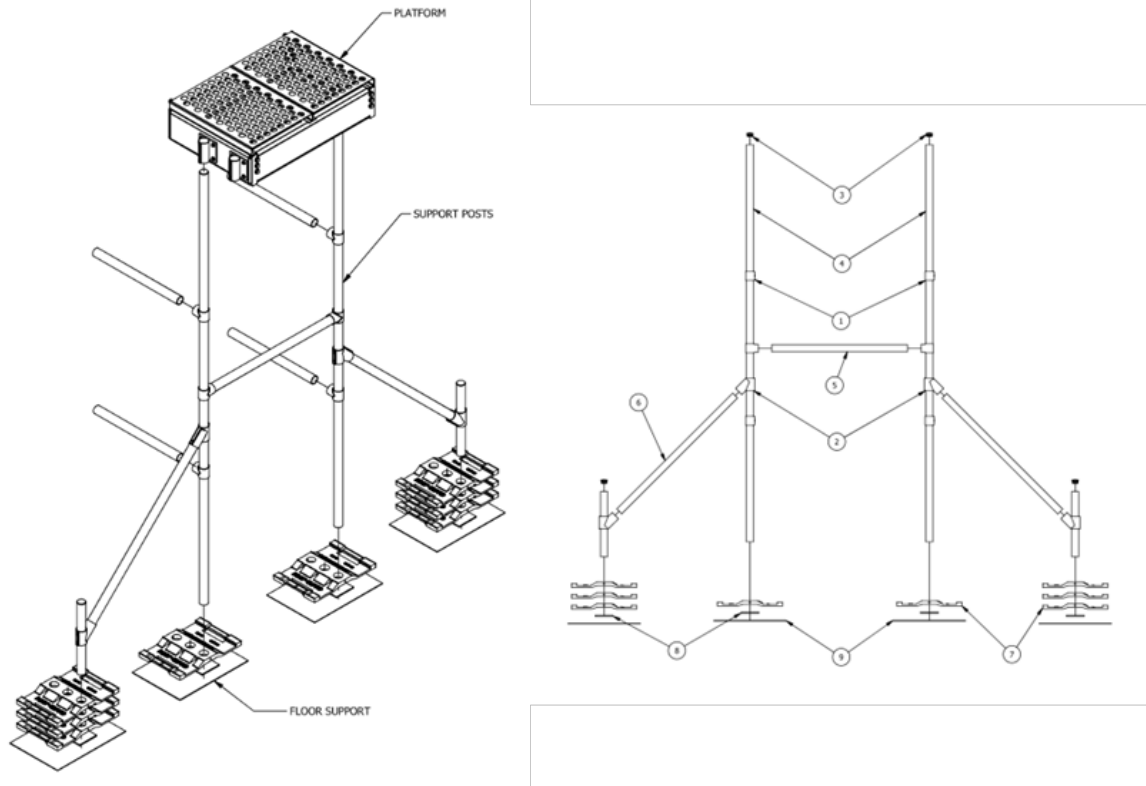

ITEM	MATERIAL CODE	DESCRIPTION	QTY
1	RGF-010	FITTING, TEE, SINGLE SOCKET, 08060	6
2	RGF-145	FITTING, ANGLE TEE 45 deg., 08080	4
3	RGF-CAP	PLASTIC PLUG FITTING, FOR 1-1/2" SCH.40 PIPE	4
4-6	MP019-145-AL	PIPE, ALUM 1 1/2 SCH 40 (0.93#/FT) - various lengths to suit	5
7	RG-BASEPLATE2	RoofGuard, 2nd Generation Base Plate 40 lbs	8
8	P25-2875-19	Safety Plate, 1/4" PL. 5" x 12" 6061 Aluminum (OPTIONAL)	4
9	RG-PAD-RUBBER	Underpad, 1/8" Masticated Rubber, .125" x 14" x 20"	4

Assembly Instructions:

- Insert railing posts through flange fittings into baseplate
- Tube flush to bottom
- Tighten set screw in flange fitting and baseplate



WARNING

Failure to Read, Understand, and Follow the Installation Manual may result in injury or death



WARNING

IMPROPER USE OR INSTALLATION OF THIS EQUIPMENT MAY CAUSE INJURY OR DEATH

Failure to Read, Understand, and Follow the Installation Manual may result in injury or death

- DO NOT** stand or climb on stair and platform handrail
- DO NOT** use handrail as a tie-off point
- DO NOT** use handrail for lifting or hoisting
- DO NOT** install modular stairs within 10-feet of any electrical lines
- DO NOT** use if any component is found defective or damaged
- DO NOT** attach banners, signs, or equipment to any part of the modular stairs

DO read and follow this document (Installation Manual) for assembling and mounting the Modular Stairs RoofStair Series.

Modular Stairs RoofStair Series systems are designed and are to be used only for their intended purpose. The use of these stair systems or their individual components for any other purpose **may cause injury or death.**

Fall Protection Warranty

Please refer to website for product warranty information.

fallsafetysolutions.com/terms-conditions/

factorysupply.com/terms-conditions/



LIFTSAFE

Liftsafe
306 Darrel Drive
Ayr, ON N0B 1E0
1 (800) 977-2005
info@liftsafegroup.com
www.liftsafegroup.com



FACTORY
SUPPLY

Factory Supply
8001 Tower Point Drive
Charlotte, NC 28227
1 (888) 242-3045
sales@factorysupply.com
www.factorysupply.com